

August 29, 2016

Ms. Elizabeth B. Lukowski
Engineering Geologist
New York State Department of Environmental Conservation
Division of Environmental Remediation, Remedial Bureau C, Section A
625 Broadway, 11th Floor
Albany, New York 12233-7017

**RE: Summary of Intrusive Activities – Underground Electrical Service Installation
Patchogue Former Manufactured Gas Plant Site
Village of Patchogue, Suffolk County, New York
Site No. 1-52-182**

Dear Ms. Lukowski:

This letter provides a summary of the recently conducted intrusive activities at the Patchogue Former Manufactured Gas Plant (MGP) site (hereinafter referred to as the “Site”). The intrusive activity was conducted in accordance with the Notice of Intrusive Site Activities submitted to your attention on June 7, 2016. The intrusive activity took place on the adjacent, off-site property located at 212 West Main Street and was associated with the installation of a subsurface electrical service to a pad-mounted transformer located on the southern side of the single site building located on the property. The installation is associated with the relocation of the overhead electrical lines formerly located on the eastern property line (the property line located between the Site and the 212 West Main Street property) to the western side of the Site. These overhead lines were relocated to facilitate implementation of the full scale remedy.

Brown and Caldwell Associates (BC), on behalf of National Grid’s Site Investigation and Remediation Group, provided environmental oversight for the work. The intrusive activities were conducted in accordance with the Health and Safety Plan (HASP) for the Site. BC implemented perimeter air monitoring in accordance with the New York State Department of Health’s (NYSDOH) Generic Community Air Monitoring Plan.

Intrusive Site Activities

The utility trench was excavated by Waste Recycling Services (WRS) between June 20, 2016 and June 28, 2016. The subsurface electrical service was installed the service connected by PSEG Long Island (PSEG) between June 29, 2016 and June 30, 2016. WRS perform the excavation of the utility trench via vacuum soil extraction and handled the soils and water generated during the installation activities (trenching activities). National Grid and PSEG reviewed the most advantageous alignment for the electrical service relocation in consideration of the remedial work to be performed on the 212 West Main Street Property. The alignment selected placed the electrical service immediately east of the planned limits of remediation located on the Site and north of the planned limits of remediation located to south of the existing building on the property and east of the

planned limits of remedial action for the Site. Refer to the attached figure for the approximate location of the newly installed electrical service. The final alignment is to be included on an updated survey of the Site and the off-site property.

The electric service installation process included vacuum soil extraction of a 12-inch wide trench to a depth of approximately 30-inches below ground surface (bgs). The trench extended approximately 147-feet from the transformer south of the off-site building to a utility pole located along the eastern side of the Site. BC monitored the soils as they were being extracted from the trench to determine if they met the definition of a source materials that would be required to addressed during full scale remediation. Saturated soils were encountered at a depth approximately two to three-feet bgs. After reaching the target depth of 30-inches bgs, PSEG partially backfilled the trench with clean sand materials that they routinely used for this type of work to create a bed for the installation of the utility line. In one area of the trench located along the southwestern corner of the building, abandoned railroad tracks and other buried utilities were discovered which prevented the trench from being excavated to the full 30-inch depth. During the electric service installation activities, WRS was onsite to dewater the excavated trench to properly allow for installation. A photographic log documenting the vacuum extraction and electric service installation work is attached for reference.

Community Air Monitoring Results

As stated above, BC implemented a CAMP during all invasive activities conducted as part of the electric service installation. An air monitoring station was placed at locations both up and downwind of the active work location for each day. Each station included a photoionization detector as well as a dust (PM10) monitor. No exceedances of the actions levels contained in the CAMP were detected during the work. The results of the CAMP monitoring have been summarized and tabulated and are presented on the attached Table 1.

Waste Management Activities

Wastes derived as part of the implementation of the electric service installation activities included soils and groundwater generated from the vacuum extraction activities. Approximate __ cubic yards of soils and approximately __ gallons of groundwater were generated. The original intent of the activities was to reuse soils which did not meet the definition of source materials as backfill. All soils me the reuse criteria, however, due to the degree of saturation observed in soils that were transferred from the vacuum unit to roll-offs staged onsite, as well as the lithology of the soils [fill material (i.e., asphalt, wood, metal, gravel, etc.)] all soils removed from the trench were characterized and transported off-site for disposal a licensed and permitted facilities. The wastes were labeled to identify their contents, origin and to provide the contact information for the National Grid Project Manager. Following waste characterization and facility approval, soil wastes (27.41 tons) were transported to Bayshore Soil Management, LLC of Keasbey, NJ for disposal; water wastes (1,100 gallons) were transported to Clean Water of New York, Inc. of Staten Island, New York. Copies of the disposal documentation are attached to this letter summary report.

Ms. Elizabeth B. Lukowski

NYSDEC

Summary of Intrusive Activities – Underground Electric Service Installation

August 29, 2016

Page 3

If you should have any questions, comments or require any additional information, please do not hesitate to contact me (516) 545-2568.

Sincerely,

A handwritten signature in dark ink, appearing to read "Sarah Aldridge", with a stylized, cursive script.

for

Sarah Aldridge

National Grid

Project Manager, Site Investigation and Remediation

Enclosure

cc: J. Nealon (NYSDOH)

P:\National_Grid\Patchogue\149322_NG_Patchogue_RDR\UG_Elec_Serv_Install\Ltr_rpt\L082916EL(electric_service_install).docx

Tables

**TABLE 1A
COMMUNITY AIR MONITORING PLAN
DUST - DOWNWIND
PATCHOGUE FORMER MGP SITE
PATCHOGUE, NEW YORK**

6/13/2016		6/20/2016		6/21/2016		6/22/2016		6/23/2016		6/24/2016		6/27/2016		6/28/2016		6/29/2016		6/30/2016	
Time	mg/m ³	Time	mg/m ³	Time	mg/m ³	Time	mg/m ³	Time	mg/m ³	Time	mg/m ³	Time	mg/m ³	Time	mg/m ³	Time	mg/m ³	Time	mg/m ³
9:56:16	0.002	8:34:46	0.020	7:11:53	0.043	7:03:24	0.014	7:00:12	0.056	6:46:51	0.123	8:19:13	0.024	6:29:25	8530.000	6:42:28	0.037	7:06:57	0.011
9:57:16	0.000	8:49:46	0.007	7:26:53	0.037	7:18:24	0.074	7:15:12	0.037	7:01:51	0.083	8:34:13	0.018	6:44:25	0.014	6:57:28	0.031	7:21:57	0.009
9:58:16	0.002	9:04:46	0.010	7:41:53	0.034	7:33:24	0.043	7:30:12	0.043	7:16:51	0.063	8:49:13	0.014	6:59:25	0.012	7:12:28	0.026	7:36:57	0.008
9:59:16	0.002	9:19:46	0.013	7:56:53	0.032	7:48:24	0.030	7:45:12	0.048	7:31:51	0.046	9:04:13	0.007	7:14:25	0.012	7:27:28	0.024	7:51:57	0.008
10:00:16	0.000	9:34:46	0.012	8:11:53	0.030	8:03:24	0.036	8:00:12	0.042	7:46:51	0.044	9:19:13	0.010	7:29:25	0.010	7:42:28	0.025	8:06:57	0.036
10:01:16	0.001	9:49:46	0.013	8:26:53	0.040	8:18:24	0.033	8:15:12	0.041	8:01:51	0.040	9:34:13	0.005	7:44:25	0.008	7:57:28	0.026	8:21:57	0.000
10:02:16	0.000	10:04:46	0.014	8:41:53	0.036	8:33:24	0.024	8:30:12	0.038	8:16:51	0.036	9:49:13	0.000	7:59:25	0.009	8:12:28	0.027	8:36:57	0.000
10:03:16	0.002	10:19:46	0.012	8:56:53	0.039	8:48:24	0.021	8:45:12	0.037	8:31:51	0.032	10:04:13	0.013	8:14:25	0.011	8:27:28	0.025	8:51:57	0.028
10:04:16	0.000	10:34:46	0.013	9:11:53	0.040	9:03:24	0.019	9:00:12	0.035	8:46:51	0.025	10:19:13	0.002	8:29:25	0.009	8:52:23	0.018	9:06:57	0.004
10:05:16	0.000	10:49:46	0.011	9:26:53	0.034	9:18:24	0.016	9:15:12	0.031	9:01:51	0.026	10:34:13	0.003	8:44:25	0.010	9:07:23	0.013	9:21:57	0.006
10:06:16	0.000	11:04:46	0.010	9:41:53	0.034	9:33:24	0.017	9:30:12	0.029	9:16:51	0.025	10:49:13	0.003	8:59:25	0.014	9:22:23	0.010	9:36:57	0.008
10:07:16	0.012	11:19:46	0.011	9:56:53	0.032	9:48:24	0.018	9:45:12	0.029	9:31:51	0.022	11:04:13	0.000	9:14:25	0.012	9:37:23	0.011	9:51:57	0.011
		11:34:46	0.012	10:11:53	0.042	10:03:24	0.026	10:00:12	0.027	9:46:51	0.023	11:19:13	0.003	9:29:25	0.014	9:52:23	0.003	10:06:57	0.012
		11:49:16	0.016	10:26:53	0.050	10:18:24	0.021	10:15:12	0.031	10:01:51	0.013	11:34:13	0.003	9:44:25	0.011	10:07:23	0.000	10:32:36	0.000
		12:04:46	0.015	10:41:53	0.041	10:33:24	0.019	10:30:12	0.039	10:16:51	0.007	11:49:13	0.003	9:59:25	0.010	10:22:23	0.003	10:36:57	0.039
		12:19:46	0.017	10:56:53	0.048	10:48:24	0.020	10:45:12	0.062			12:04:13	0.000	10:14:25	0.010	10:37:23	0.003	10:51:57	0.003
		12:34:46	0.020	11:11:53	0.039	11:03:24	0.010	11:00:12	0.050			12:19:13	0.004	10:29:25	0.014	10:52:23	0.002	11:06:57	0.001
		12:49:46	0.019	11:26:53	0.038	11:18:24	0.024	11:15:12	0.042			12:34:13	0.000	10:44:25	0.012	11:07:23	0.002	11:21:57	0.000
		13:04:46	0.020	11:41:53	0.029	11:33:24	0.024	11:30:12	0.036					10:59:25	0.014	11:22:23	0.003	11:36:57	0.001
		13:19:46	0.020	11:56:53	0.023	11:48:24	0.026	11:45:12	0.039					11:14:25	0.014	11:37:23	0.002		
		13:34:46	0.020	12:11:53	0.020	12:03:24	0.013	12:00:12	0.047					11:29:25	0.015	11:52:23	0.001		
		13:49:46	0.020	12:26:53	0.018	12:18:24	0.010	12:15:12	0.033					11:44:25	0.013	12:07:23	0.004		
		14:04:46	0.022	12:41:53	0.021	12:33:24	0.008	12:30:12	0.031					11:59:25	0.011	12:22:23	0.005		
		14:19:46	0.022	12:56:53	0.021	12:48:24	0.015	12:45:12	0.034					12:14:25	0.013	12:37:23	0.006		
		14:34:46	0.023	13:11:53	0.018	13:03:24	0.030	13:00:12	0.037					12:29:25	0.012	12:52:23	0.006		
		14:49:46	0.021	13:26:53	0.013	13:18:24	0.023	13:15:12	0.034					12:44:25	0.011	13:07:23	0.023		
		15:04:46	0.021	13:41:53	0.009	13:33:24	0.022	13:30:12	0.035					12:59:25	0.011	13:22:23	0.008		
			0.581	13:56:53	0.008	13:48:24	0.028	13:45:12	0.030							13:37:23	0.009		
			0.592	14:11:53	0.005	14:03:24	0.021	14:00:12	0.027							13:52:23	0.013		
			0.602	14:26:53	0.003	14:18:24	0.018	14:15:12	0.020							14:07:23	0.013		
			0.612	14:41:53	0.002	14:33:24	0.019									14:22:23	0.023		
			0.623	14:56:53	0.003	14:48:24	0.025									14:37:23	0.023		
																14:52:23	0.025		
																15:07:23	0.025		
																15:22:23	0.033		

Notes:
Bold and Boxed values indicates dust levels 0.5 mg/m³ above background
BOLD values indicate an irregularity of reading at machine start-up

**TABLE 1B
COMMUNITY AIR MONITORING PLAN
VOCs - DOWNWIND
PATCHOGUE FORMER MGP SITE
PATCHOGUE, NEW YORK**

6/13/2016		6/20/2016		6/21/2016		6/22/2016		6/23/2016		6/24/2016		6/27/2016		6/28/2016		6/29/2016		6/30/2016	
Time	VOC (ppb)	Time	VOC (ppb)	Time	VOC (ppb)	Time	VOC (ppb)	Time	VOC (ppb)	Time	VOC (ppb)	Time	VOC (ppb)	Time	VOC (ppb)	Time	VOC (ppb)	Time	VOC (ppb)
10:17:08	0	8:50:38	2	7:25:11	2	7:18:48	0	7:22:05	0	7:07:30	0	8:42:01	0	7:03:27	0	7:05:12	2959	7:18:37	0
		9:05:38	0	7:40:11	0	7:33:48	0	7:37:05	0	7:22:30	0	8:57:01	0	7:18:27	0	7:20:12	1736	7:33:37	0
		9:20:38	0	7:55:11	0	7:48:48	0	7:52:05	0	7:37:30	0	9:12:01	0	7:33:27	0	7:35:12	377	7:48:37	0
		9:35:38	1	8:10:11	0	8:03:48	0	8:07:05	0	7:52:30	0	9:27:01	0	7:48:27	0	7:50:12	0	8:03:37	0
		9:50:38	0	8:25:11	0	8:18:48	0	8:22:05	0	8:07:30	0	9:42:01	0	8:03:27	0	8:05:12	0	8:18:37	0
		10:05:38	0	8:40:11	0	8:33:48	0	8:37:05	0	8:22:30	0	9:57:01	0	8:18:27	0	8:20:12	0	8:33:37	0
		10:20:38	0	8:55:11	0	8:48:48	0	8:52:05	0	8:37:30	0	10:12:01	0	8:33:27	0	8:35:12	0	8:48:37	0
		10:35:58	0	9:10:11	0	9:03:48	0	9:07:05	0	8:52:30	0	10:27:01	0	8:48:27	0	8:50:12	0	9:03:37	0
		10:50:38	0	9:25:11	0	9:18:48	0	9:22:05	0	9:07:30	0	10:42:01	0	9:03:27	0	9:16:51	0	9:18:37	0
		11:05:58	0	9:40:11	0	9:33:48	0	9:37:05	0	9:22:30	0	10:57:01	0	9:18:27	0	9:31:51	0	9:33:37	0
		11:20:58	0	9:55:11	0	9:48:48	0	9:52:05	0	9:37:30	0	11:12:01	0	9:33:27	0	9:46:51	0	9:48:37	0
		11:35:58	0	10:10:11	0	10:03:48	0	10:07:05	0	9:52:30	0	11:27:01	0	9:48:27	29	10:01:51	0	10:03:37	0
		11:50:58	0	10:25:11	0	10:18:48	0	10:22:05	0	10:07:30	0	11:42:01	0	10:03:27	0	10:16:51	0	10:18:37	0
		12:05:58	0	10:40:11	0	10:33:48	0	10:37:05	0	10:22:30	0	11:57:01	0	10:18:27	0	10:31:51	0	10:33:37	0
		12:20:58	0	10:55:11	0	10:48:48	0	10:52:05	0	10:37:30	0	12:12:01	0	10:33:27	0	10:46:51	0		
		12:35:58	0	11:10:11	0	11:03:48	0	11:07:05	0			12:27:01	0	10:48:27	0	11:01:51	0		
		12:50:58	0	11:25:11	0	11:18:48	0	11:22:05	0			12:42:01	0	11:03:27	0	11:16:51	0		
		13:05:58	0	11:40:11	0	11:33:48	0	11:37:05	0			12:57:01	0	11:18:27	0	11:31:51	0		
		13:20:58	0	11:55:11	0	11:48:48	0	11:52:05	0					11:33:27	0	11:46:51	0		
		13:35:58	0	12:10:11	0	12:03:48	0	12:07:05	0					11:48:27	0	12:01:51	0		
		13:50:58	0	12:25:11	0	12:18:48	0	12:22:05	0					12:03:27	0	12:16:51	0		
		14:05:58	0	12:40:11	0	12:33:48	0	12:37:05	0					12:18:27	0	12:31:51	0		
		14:20:58	0	12:55:11	0	12:48:48	0	12:52:05	0					12:33:27	0	12:46:51	0		
		14:35:58	0	13:10:11	0	13:03:48	0	13:07:05	0					12:48:27	0	13:01:51	0		
		14:50:58	0	13:25:11	0	13:18:48	0	13:22:05	0					13:03:27	0	13:16:51	0		
		15:05:58	0	13:40:11	0	13:33:48	0	13:37:05	0					13:18:27	0	13:31:51	0		
		15:20:58	0	13:55:11	0	13:48:48	0	13:52:05	0					13:33:27	0	13:46:51	0		
		15:35:58	0	14:10:11	0	14:03:48	0	14:07:05	0					11:18:27	0	14:01:51	0		
				14:25:11	0	14:18:48	0	14:22:05	0					11:33:27	0	14:16:51	0		
				14:40:11	0	14:33:48	0	14:37:05	0					11:48:27	0	14:31:51	0		
				14:55:11	0	14:48:48	0							12:03:27	0	14:46:51	0		
				15:10:11	0	15:03:48	0							12:18:27	0	15:01:51	0		
														12:33:27	0	15:16:51	0		
														12:48:27	0	15:31:51	0		
														13:03:27	0	15:46:51	0		
														13:18:27	0				
														13:33:27	0				

Notes:
Bold and Boxed values indicate VOC detection above 5000 ppb above background

TABLE 1C
COMMUNITY AIR MONITORING PLAN
DUST - UPWIND
PATCHOGUE FORMER MGP SITE
PATCHOGUE, NEW YORK

6/13/2016		6/20/2016		6/21/2016		6/22/2016		6/23/2016		6/24/2016		6/27/2016		6/28/2016		6/29/2016 ^(a)		6/30/2016	
Time	mg/m ³	Time	mg/m ³	Time	mg/m ³	Time	mg/m ³	Time	mg/m ³	Time	mg/m ³	Time	mg/m ³	Time	mg/m ³	Time	mg/m ³	Time	mg/m ³
9:49:10	0.027	8:38:43	0.008	7:13:16	0.031	7:01:34	0.029	7:01:20	0.034	6:51:05	0.099	8:20:31	0.040	6:29:11	8530.000			7:02:46	0.017
9:50:10	0.010	8:53:43	0.003	7:28:16	0.025	7:16:34	0.016	7:16:20	0.019	7:06:05	0.063	8:35:31	0.007	6:44:11	0.016			7:17:46	0.019
9:51:10	0.003	9:08:43	0.003	7:43:16	0.026	7:31:34	0.018	7:31:20	0.019	7:21:05	0.046	8:50:31	0.005	6:59:11	0.004			7:32:46	0.019
9:52:10	0.007	9:23:43	0.003	7:58:16	0.035	7:46:34	0.018	7:46:20	0.017	7:36:05	0.031	9:05:31	0.005	7:14:11	0.002			7:47:46	0.019
9:53:10	0.002	9:38:43	0.003	8:13:16	0.032	8:01:34	0.018	8:01:20	0.020	7:51:05	0.029	9:20:31	0.012	7:29:11	0.001			8:02:46	0.004
9:54:10	0.004	9:53:43	0.004	8:28:16	0.030	8:16:34	0.017	8:16:20	0.025	8:06:05	0.029	9:35:31	0.009	7:44:11	0.000			8:17:46	0.020
9:55:10	0.007	10:08:43	0.003	8:43:16	0.032	8:31:34	0.014	8:31:20	0.022	8:21:05	0.045	9:50:31	0.006	7:59:11	0.000			8:32:46	0.020
9:56:10	0.004	10:23:43	0.002	8:58:16	0.035	8:46:34	0.012	8:46:20	0.020	8:36:05	0.021	10:05:31	0.026	8:14:11	0.000			8:47:46	0.019
9:57:10	0.002	10:38:43	0.003	9:13:16	0.038	9:01:34	0.012	9:01:20	0.019	8:51:05	0.021	10:20:31	0.014	8:29:11	0.000			9:02:46	0.015
9:58:10	0.002	10:53:43	0.003	9:28:16	0.029	9:16:34	0.013	9:16:20	0.019	9:06:05	0.024	10:35:31	0.005	8:44:11	0.000			9:17:46	0.020
9:59:10	0.002	11:08:43	0.003	9:43:16	0.027	9:31:34	0.013	9:31:20	0.018	9:21:05	0.014	10:50:31	0.005	8:59:11	0.000			9:32:46	0.020
10:00:10	0.002	11:23:43	0.003	9:58:16	0.023	9:46:34	0.014	9:46:20	0.029	9:36:05	0.016	11:05:31	0.007	9:14:11	0.000			9:47:46	0.020
10:01:10	0.003	11:38:43	0.003	10:13:16	0.030	10:01:34	0.015	10:01:20	0.018	9:51:05	0.023	11:20:31	0.007	9:29:11	0.001			10:02:46	0.021
10:02:10	0.004	11:53:43	0.003	10:28:16	0.032	10:16:34	0.015	10:16:20	0.018	10:06:05	0.019	11:35:31	0.007	9:44:11	0.001			10:31:46	0.000
10:03:10	0.002	12:08:43	0.004	10:43:16	0.028	10:31:34	0.016	10:31:20	0.021			11:50:31	0.006	9:59:11	0.000			10:32:46	0.031
10:04:10	0.003	12:23:43	0.003	10:58:16	0.070	10:46:34	0.017	10:46:20	0.029			12:05:31	0.005	10:14:11	0.001			10:47:46	0.006
10:05:10	0.003	12:38:43	0.003	11:13:16	0.030	11:01:34	0.017	11:01:20	0.030			12:20:31	0.005	10:29:11	0.002			11:02:46	0.008
10:06:10	0.002	12:53:43	0.004	11:28:16	0.032	11:16:34	0.017	11:16:20	0.028			12:35:31	0.005	10:44:11	0.003			11:17:46	0.010
		13:08:43	0.004	11:43:16	0.027	11:31:34	0.019	11:31:20	0.028					10:59:11	0.003			11:32:46	0.012
		13:23:43	0.003	11:58:16	0.023	11:46:34	0.018	11:46:20	0.026					11:14:11	0.003			11:47:46	0.011
		13:38:43	0.004	12:13:16	0.022	12:01:34	0.020	12:01:20	0.023					11:29:11	0.004				
		13:53:43	0.003	12:28:16	0.022	12:16:34	0.021	12:16:20	0.022					11:44:11	0.003				
		14:08:43	0.003	12:43:16	0.023	12:31:34	0.020	12:31:20	0.022					11:59:11	0.001				
		14:23:43	0.004	12:58:16	0.024	12:46:34	0.020	12:46:20	0.021					12:14:11	0.001				
		14:38:43	0.004	13:13:16	0.020	13:01:34	0.020	13:01:20	0.021					12:29:11	0.001				
				13:28:16	0.017	13:16:34	0.023	13:16:20	0.023					12:44:11	0.000				
				13:43:16	0.015	13:31:34	0.023	13:31:20	0.025					12:59:11	0.000				
				13:58:16	0.016	13:46:34	0.025	13:46:20	0.022										
				14:13:16	0.014	14:01:34	0.026	14:01:20	0.019										
				14:28:16	0.014	14:16:34	0.029	14:16:20	0.016										
				14:43:16	0.017	14:31:34	0.028												
				14:58:16	0.017	14:46:34	0.056												

Notes:
Bold and Boxed values indicates dust levels 0.5 mg/m³ above background
BOLD values indicate an irregularity of reading at machine start-up

**TABLE 1D
COMMUNITY AIR MONITORING PLAN
VOCs - UPWIND
PATCHOGUE FORMER MGP SITE
PATCHOGUE, NEW YORK**

6/13/2016		6/20/2016		6/21/2016		6/22/2016		6/23/2016		6/24/2016		6/27/2016		6/28/2016		6/29/2016		6/30/2016	
Time	VOC (ppb)	Time	VOC (ppb)	Time	VOC (ppb)	Time	VOC (ppb)	Time	VOC (ppb)	Time	VOC (ppb)	Time	VOC (ppb)	Time	VOC (ppb)	Time	VOC (ppb)	Time	VOC (ppb)
8:22:07	0	8:54:39	0	6:37:39	1	6:26:54	0	7:20:22	0	6:11:51	3	7:46:00	1	6:08:21	3	6:17:16	4	6:22:24	0
8:37:07	0	9:09:39	0	6:52:39	1	6:41:54	0	7:35:22	0	6:26:51	1	8:01:00	1	6:23:21	5	6:32:16	4	6:37:24	0
8:52:07	0	9:24:39	0	7:07:39	1	6:56:54	0	7:50:22	0	6:41:51	1	8:16:00	1	6:38:21	4	6:47:16	2	6:52:24	0
9:07:07	0	9:39:39	0	7:22:39	1	7:11:54	0	8:05:22	0	6:56:51	1	8:31:00	0	6:53:21	3	7:02:16	1	7:07:24	1
		9:54:39	0	7:37:39	0	7:26:54	0	8:20:22	0	7:11:51	0	8:46:00	0	7:08:21	2	7:17:16	0	7:22:24	1
		10:09:39	0	7:52:39	0	7:41:54	0	8:35:22	0	7:26:51	0	9:01:00	0	7:23:21	2	7:32:16	0	7:37:24	2
		10:24:39	0	8:07:39	0	7:56:54	0	8:50:22	0	7:41:51	0	9:16:00	0	7:38:21	2	7:47:16	0	7:52:24	2
		10:53:05	0	8:22:39	0	8:11:54	0	9:05:22	0	7:56:51	0	9:31:00	0	7:53:21	2	8:02:16	0	8:07:24	2
		11:08:05	0	8:37:39	0	8:26:54	0	9:20:22	0	8:11:51	0	9:46:00	0	8:08:21	2	8:17:16	0	8:22:24	3
		11:23:05	1	8:52:39	0	8:41:54	0	9:35:22	0	8:26:51	0	10:01:00	0	8:23:21	2	8:32:16	0	8:37:24	3
		11:38:05	1	9:07:39	0	8:56:54	0	9:50:22	0	8:41:51	0	10:16:00	0	8:38:21	2	8:47:16	0	8:52:24	3
		11:53:05	1	9:22:39	0	9:11:54	0	10:05:22	0	8:56:51	0	10:31:00	0	8:53:21	2	9:02:16	0	9:07:24	3
		42541.5056	1	9:37:39	0	9:26:54	0	10:20:22	0	9:11:51	0	10:46:00	0	9:08:21	2	9:17:16	0	9:22:24	3
		42541.516	2	9:52:39	0	9:41:54	0	10:35:22	0	9:26:51	0	11:01:00	0	9:23:21	2	9:32:16	0	10:15:51	4
		42541.5264	1	10:07:39	0	9:56:54	0	10:50:22	0	9:41:51	0	11:16:00	0	9:38:21	2	9:47:16	0	10:30:51	4
		42541.5369	0	10:22:39	0	10:11:54	0	11:05:22	0			11:31:00	0	9:53:21	2	10:02:16	0	10:45:51	4
		42541.5473	0	10:37:39	0	10:26:54	0	11:20:22	0			11:46:00	0	10:08:21	2	10:17:16	0	11:00:51	4
		42541.5577	0	10:52:39	0	10:41:54	0	11:35:22	0			12:01:00	0	10:23:21	2	10:32:16	0	11:15:51	4
		42541.5681	0	11:07:39	0	10:56:54	0	11:50:22	0					10:38:21	2	10:47:16	0		
		42541.5785	0	11:22:39	0	11:11:54	0	12:05:22	0					10:53:21	2	11:02:16	0		
		42541.5889	0	11:37:39	0	11:26:54	0	12:20:22	0					11:08:21	2	11:17:16	0		
		42541.5994	0	11:52:39	0	11:41:54	0	12:35:22	0					11:23:21	2	11:32:16	0		
		42541.6098	0	12:07:39	0	11:56:54	0	12:50:22	0					11:38:21	2	11:47:16	0		
				12:22:39	0	12:11:54	0	13:05:22	0					11:53:21	2	12:02:16	0		
				12:37:39	0	12:26:54	0	13:20:22	0					12:08:21	2	12:17:16	0		
				12:52:39	0	12:41:54	0	13:35:22	0					12:23:21	2	12:32:16	0		
				13:07:39	0	12:56:54	0	13:50:22	0					12:38:21	2	12:47:16	0		
				13:22:39	0	13:11:54	0	14:05:22	0							13:02:16	0		
				42542.5678	0	13:26:54	0	14:20:22	0							13:17:16	0		
				42542.5782	0	13:41:54	0	14:35:22	0							13:32:16	0		
				42542.5886	0	13:56:54	0	14:50:22	0							13:47:16	0		
				42542.5991	0	14:11:54	0	15:05:22	0							14:02:16	0		
																14:17:16	0		
																14:32:16	0		
																14:47:16	0		

Notes:

Bold and Boxed values indicate VOC detection above 5000 ppb above background

Figures

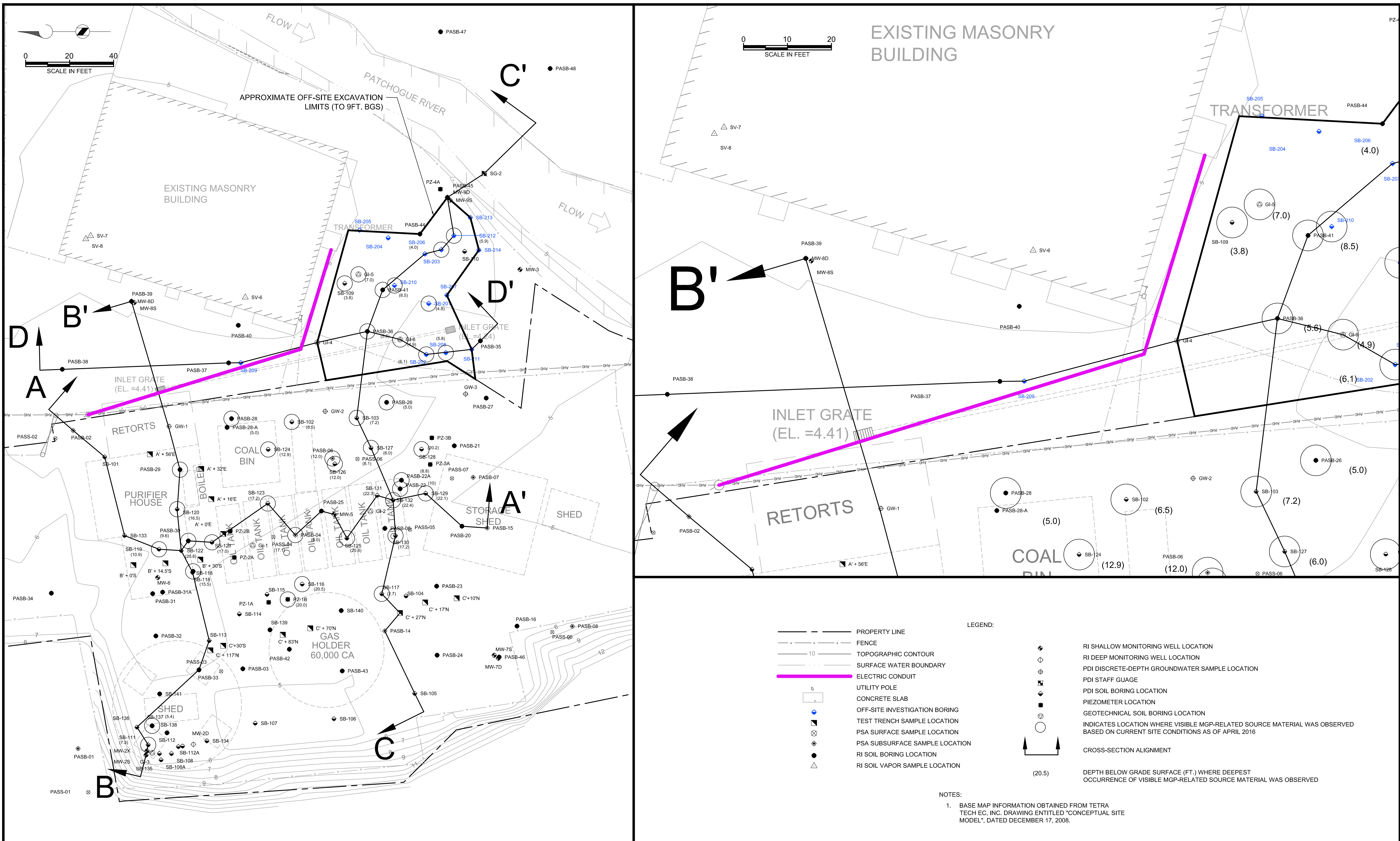

Attachment: Photographic Log



Photograph #1 – Alignment of trench south of off-site building, prior to intrusive activities.



Photograph #2 – Alignment of trench west of off-site building, prior to intrusive activities



Photograph #3 – Saw cutting and removal asphalt along trench alignment south of off-site building.



Photograph #4 – Vacuum extraction of soils to 30-inches bgs for underground electric service installation.



Photograph #5 – Transfer of wastes from the vacuum soil extraction unit into lined roll-off containers off-site disposal.



Photograph #6 – Vacuum extraction of soils underground electric service installation. Image notes buried utilities and abandoned railroad tracks.



Photograph #7 – PSEG Long Island onsite to de-energize transformer to facilitation electric service installation.



Photograph #8 – Removal of section of railroad track to facilitate electric service installation.
Image notes dewatering activities.



Photograph #9 – PSEG Long Island installation of underground electric service. Schedule 80 PVC used where electric line had potential to come into contact with metal debris (railroad track), or trench depth did not meet prescribed depth of 30-inches bgs.



Photograph #10 – Backfilling activities.



Photograph #11 – Images notes section of underground electric installation encased in concrete due to shallow depth where abandoned railroad tracks were encountered near utility pole.

Attachment: Waste Disposal Manifests



Clean Water of New York, Inc.
3249 Richmond Terrace
Staten Island, NY 10303
Phone: 718-981-4600 Fax: 718-981-5213

JOB RECEIPT

Job Number	Date	Time	Job Type
JOB0146657	7/18/16	9:00 am	Truck Job

Generator	
NATIONAL GRID 175 East Old Country Rd. Hicksville, NY 11801 (631) 300-7599 EPA Permit #	
Customer	
INNOVATIVE RECYCLING TECH, INC 690 N. Queens Avenue Lindenhurst, NY 11757 PO #: JD415 Job # Profile Sheet: Yes Approval Code: 47-009	

Transporter	
WASTE RECYCLING SOLUTIONS, INC 17 Old Dock Road County Road 101 Yaphank, NY 11980 EPA Permit #: NYR000188490 NYS DEC Permit #: 1A-415 Transport / Vessel: VAC # 87 # of Tanks: 1 Total Capacity: 3,200 U of M: Gallons	

Site / Vessel Name: NATIONAL GRID, HICKSVILLE, NY

Received 1,100 Gallons Of Oily Water For Proper Treatment and Disposal.

Products & Test Results	Category	Code	Description	Quantity	UoM
	D	N018	Oily Water	1,100	Gallons
Compartment	% Water	% Oil	% Solid	Halogens (ppm)	Flash Point (oF)
1	98.00	1.00	1.00	0	>= 100
Other Tests Performed: No					

Did this load or any portion of this load originate at a utility? Yes

008399

Receiver's Signature and Date
7/18/2016 9:00 am

Generator's Representative Signature and Date

8732

NON-HAZARDOUS WASTE MANIFEST		1. Generator ID Number NYD00686608	2. Page 1 of 1	3. Emergency Response Phone 631-924-8111	4. Waste Tracking Number WRS008399	
5. Generator's Name and Mailing Address National Grid 175 E Old Country Rd Hicksville N.Y. 11801			Generator's Site Address (if different than mailing address) Same 212 W MAIN ST Patchogue			
6. Transporter 1 Company Name WRS Environmental Services, Inc.			U.S. EPA ID Number NYR000188490			
7. Transporter 2 Company Name			U.S. EPA ID Number			
8. Designated Facility Name and Site Address Clean Water of New York 3245 Richmond Terrace STATEN ISLAND, N.Y. 10303			U.S. EPA ID Number N/A			
Facility's Phone:						
9. Waste Shipping Name and Description			10. Containers		11. Total Quantity	12. Unit Wt./Vol.
			No.	Type		
1. Non DOT / Non RCRA Regulated			1	TT	1,100	G
2.						
3.						
4.						
13. Special Handling Instructions and Additional Information IN An Emergency CALL 631-924-8111 Oily Water Approval # 47-118						
14. GENERATOR'S CERTIFICATION: I certify the materials described above on this manifest are not subject to federal regulations for reporting proper disposal of Hazardous Waste.						
Generator's/Officer's Printed/Typed Name Kenneth S. Reynolds			Signature [Signature]		Month Day Year 7/18/16	
15. International Shipments <input type="checkbox"/> Import to U.S. <input type="checkbox"/> Export from U.S. Port of entry/exit: Date leaving U.S.:						
16. Transporter Acknowledgment of Receipt of Materials						
Transporter 1 Printed/Typed Name Kenneth S. Reynolds			Signature [Signature]		Month Day Year 7/18/16	
Transporter 2 Printed/Typed Name			Signature		Month Day Year	
17. Discrepancy						
17a. Discrepancy Indication Space <input type="checkbox"/> Quantity <input type="checkbox"/> Type <input type="checkbox"/> Residue <input type="checkbox"/> Partial Rejection <input type="checkbox"/> Full Rejection						
Manifest Reference Number:						
17b. Alternate Facility (or Generator) U.S. EPA ID Number						
Facility's Phone:						
17c. Signature of Alternate Facility (or Generator) Month Day Year						
18. Designated Facility Owner or Operator: Certification of receipt of materials covered by the manifest except as noted in Item 17a						
Printed/Typed Name William J. [Signature]			Signature [Signature]		Month Day Year 7/18/16	

GENERATOR

INTL

TRANSPORTER

DESIGNATED FACILITY

PT4194

Bayshore Recycling Corp.
75 Crows Mill Rd
PO Box 290
Keasbey, NJ 08832

Facility ID: 132397

Ticket: 682964
Date: 8/22/2016
Time: 08:37:31 - 09:31:42

Customer: WAS ENVIRONMENTAL SERVICES,
INC./BSM0056
17 OLD DOCK ROAD
YAPHANK, NY 11980-
Truck: 35019PC

Scale
Gross: 60300 lb In Scale 2
Tare: 36900 lb Out Scale 4
Net: 23400 lb

CUYDs: 25 License: 35019PC
Truck Type: ROLLOFF

Carrier: WASTE RECYCLING SOLUTIONS

Manifest: NY356
Remaining: 0.00 TN

Profile: 2716-1064/NATIONAL GRID PATCHOGUE FORMER MGP
Generator: NATIONAL GRID PATCHOGUE FORMER MGP
Comment:

Origin	Materials & Services	Quantity	Unit
Long Island	ID27 NHCT	11.70	Tons

THE ABOVE IS CORRECT AND NON-HAZARDOUS TO THE BEST OF MY KNOWLEDGE

Driver: Kennerly

Weighmaster: Mark

PT# 17007
Jb# 8732

PKS

PLATE 35019 PC

NON-HAZARDOUS WASTE MANIFEST		1. Generator ID Number NY 000686008		2. Page 1 of 1		3. Emergency Response Phone 631 924-8111		4. Waste Tracking Number NY 350	
5. Generator's Name and Mailing Address NATIONAL GRID 175 E OLD COUNTRY RD HICKSVILLE NY 11801						Generator's Site Address (if different than mailing address) NATIONAL GRID 212 W MAIN ST PATCHOGUE NY			
6. Transporter 1 Company Name WRS Environmental Services, Inc.						U.S. EPA ID Number NYR000188490			
7. Transporter 2 Company Name						U.S. EPA ID Number			
8. Designated Facility Name and Site Address Bayshore Solid Waste Management 75 Crows Mill Road Kearney NJ 08832 732 7386000						U.S. EPA ID Number NJ1225001522			
9. Waste Shipping Name and Description 1. Non DOT/Non RCRA Regulated Solids						10. Containers		11. Total Quantity 00020	12. Unit Wt./Vol. Y
						No.	Type		
						001	CM		
2.									
3.									
4.									
13. Special Handling Instructions and Additional Information Dirt & Debris Bx# RT 4194 APPROVAL BSM 2716-1064									
14. GENERATOR'S CERTIFICATION: I certify the materials described above on this manifest are not subject to federal regulations for reporting proper disposal of Hazardous Waste. Generator's/Officer's Printed/Typed Name: Kenneth S Reynolds Signature: [Signature] Month: 8 Day: 22 Year: 16									
15. International Shipments <input type="checkbox"/> Import to U.S. <input type="checkbox"/> Export from U.S. Port of entry/exit: _____ Date leaving U.S.: _____									
16. Transporter Acknowledgment of Receipt of Materials Transporter 1 Printed/Typed Name: Kenneth S Reynolds Signature: [Signature] Month: 8 Day: 22 Year: 16 Transporter 2 Printed/Typed Name: _____ Signature: _____ Month: _____ Day: _____ Year: _____									
17. Discrepancy 17a. Discrepancy Indication Space <input type="checkbox"/> Quantity <input type="checkbox"/> Type <input type="checkbox"/> Residue <input type="checkbox"/> Partial Rejection <input type="checkbox"/> Full Rejection Manifest Reference Number: _____ 17b. Alternate Facility (or Generator) _____ U.S. EPA ID Number: _____ Facility's Phone: _____ 17c. Signature of Alternate Facility (or Generator) _____ Month: _____ Day: _____ Year: _____									
18. Designated Facility Owner or Operator: Certification of receipt of materials covered by the manifest except as noted in Item 17a Printed/Typed Name: Richard X Houshaka Signature: [Signature] Month: 8 Day: 22 Year: 16									

GENERATOR

TRANSPORTER INT'L

DESIGNATED FACILITY

Bayshore Recycling Corp.
75 Crows Mill Rd
PO Box 290
Keasbey, NJ 08832

Facility ID: 132397

Ticket: 682954

Date: 8/22/2016

Time: 08:38:18 - 09:26:47

Scale

Customer: WRS ENVIRONMENTAL SERVICES,
INC./BSM0056
17 OLD DOCK ROAD
YAPHANK, NY 11980-

Gross: 66960 lb In Scale 1
Tare: 35540 lb Out Scale 4
Net: 31420 lb

Truck: 44138PC

CUYDs: 20

License: 44138PC
Truck Type: ROLLOFF

Carrier: WRS ENVIRONMENTAL SERVICES

Manifest: NY355
Remaining: 0.00 TN

Profile: 2716-1064/NATIONAL GRID PATCHOGUE FORMER MSP
Generator: NATIONAL GRID PATCHOGUE FORMER MSP

Comment:

Origin	Materials & Services	Quantity	Unit
Long Island	ID27 MHCT	15.71	Tons

THE ABOVE IS CORRECT AND NON-HAZARDOUS TO THE BEST OF MY KNOWLEDGE

Driver: CHRIS

Weighmaster: Mark

Post # 1207
Sub # 8732

RT 2849 Disposal

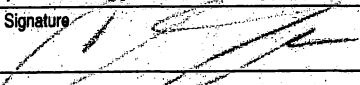
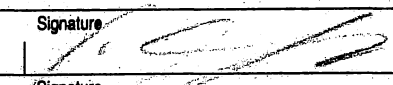
NON-HAZARDOUS WASTE MANIFEST		1. Generator ID Number NY D006868008	2. Page 1 of 1	3. Emergency Response Phone 631 924-8111	4. Waste Tracking Number NY 355	
5. Generator's Name and Mailing Address NATIONAL GRID 175 E OLD COUNTRY RD HICKSVILLE NY 11801			Generator's Site Address (if different than mailing address) NATIONAL GRID 212 W MAIN ST PATCHOGUE NY			
Generator's Phone:						
6. Transporter 1 Company Name WRS Environmental Services, Inc.			U.S. EPA ID Number NY R000188490			
7. Transporter 2 Company Name			U.S. EPA ID Number			
8. Designated Facility Name and Site Address Bayshore Soil Management 75 Crows Mill Road Kearney NJ 08832			U.S. EPA ID Number NJ 1225001522			
Facility's Phone: 732 7386000						
9. Waste Shipping Name and Description		10. Containers		11. Total Quantity	12. Unit Wt./Vol.	
		No.	Type			
1. Non DOT Non RCRA Regulated Solids		001	CM	00020	Y	
2.						
3.						
4.						
13. Special Handling Instructions and Additional Information APPROVAL BSM 2716-1064						
14. GENERATOR'S CERTIFICATION: I certify the materials described above on this manifest are not subject to federal regulations for reporting proper disposal of Hazardous Waste.						
Generator's/Officer's Printed/Typed Name As Agent For Ngid. Chris Phelan			Signature 		Month Day Year 08 22 16	
15. International Shipments <input type="checkbox"/> Import to U.S. <input type="checkbox"/> Export from U.S. Port of entry/exit: Date leaving U.S.:						
16. Transporter Acknowledgment of Receipt of Materials						
Transporter 1 Printed/Typed Name Chris Phelan			Signature 		Month Day Year 8 22 16	
Transporter 2 Printed/Typed Name			Signature		Month Day Year	
17. Discrepancy						
17a. Discrepancy Indication Space <input type="checkbox"/> Quantity <input type="checkbox"/> Type <input type="checkbox"/> Residue <input type="checkbox"/> Partial Rejection <input type="checkbox"/> Full Rejection						
Manifest Reference Number:						
17b. Alternate Facility (or Generator)			U.S. EPA ID Number			
Facility's Phone:						
17c. Signature of Alternate Facility (or Generator)			Month Day Year			
18. Designated Facility Owner or Operator: Certification of receipt of materials covered by the manifest except as noted in Item 17a						
Printed/Typed Name			Signature		Month Day Year	

GENERATOR
INT'L
TRANSPORTER
DESIGNATED FACILITY